



Scottish Borders Social Enterprise Chamber Newsletter

July 2010

Volume 25

Business on Board

Scottish Business in the Community has linked up with the Scottish Council for Voluntary Organisations to promote Business on Board, a new programme to encourage dialogue and exchange between the private and third sectors.

Third sector organisations - charities, voluntary organisations, social enterprises, community organisations - benefit from the business knowledge of colleagues in the private sector. In return, the third sector can offer important insights to help better target valuable CSR initiatives.

The Business on Board programme has been developed to help broker that support by encouraging and supporting people with business skills to join their boards. This offers mutual benefits and opportunities on a business and individual level.

Further information on the programme can be obtained from Scottish Business in the Community's Borders Coordinator, Ian Skinner on 01835 822823 or log onto <http://www.scvo.org.uk/businessonboard>.

Dormant Bank Accounts

This week the Scottish Parliament approved the Dormant Bank Account Order (2010) - and will now consult on how the money will be allocated. Over time the sum available will be circa £30m and the general purpose – to promote resilient communities. One of the options to be considered (the one Senscot has been punting) is to endow a Trust - which can assist our poorer communities for years to come. Instead of the usual stocks and shares, the Trust could invest the £30m in community owned windpower generation. If this investment achieved 10% - this would provide our 30 poorest communities with an annuity of £100k - to kickstart their own Development Trust - get local community enterprise underway. This is a once in a generation opportunity to endow something permanent.

Planning Aid

Planning Aid Scotland (PAS) has launched a new mentoring scheme to help community groups take advantage of their local resources in areas such as a renewable energy scheme, community hall, allotments, or affordable housing by offering free planning advice and training to rural community groups.

The launch of the scheme demonstrates the growth and development of Planning Aid for Scotland and the increasing demand for impartial planning advice, information and support. For more information go to www.planningaidscotland.org.uk

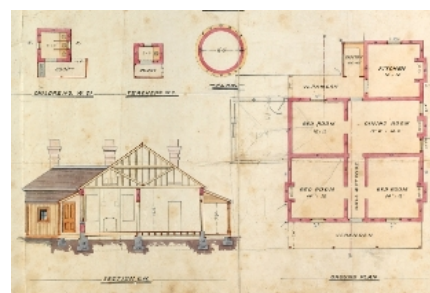

Shop Front Grant Scheme

Scottish Borders Council has allocated limited funds in the current financial year to provide grant support towards repairs and enhancement works to shop fronts in town centers of the main Border towns. The purpose of the grant scheme is to:

- Enhance the shopping environment in town centers;
- Restore historical features to enhance the conservation identity of town centers;
- Remove blight from the high street;
- Improve the socio economic performance of town centers.

A total of £60,000 has been allocated to the scheme in the current financial year. Grants will be assessed in 2 rounds. Applications should be submitted before the following deadlines:

Round 1	30 July 2010
Round 2	1 October 2010

The Grant Scheme is only available in financial year 2010/11 and is available in following settlements:

Coldstream	Duns	Earlston	Eyemouth
Galashiels	Hawick	Innerleithen	Jedburgh
Kelso *	Lauder	Melrose	Newcastleton
Newtown St Boswells		Peebles	Selkirk
St Boswells	West Linton		

* Applications from Kelso will be funded from this grant scheme or if appropriate used as expressions of interest for other funding opportunities such as the Kelso THI in the forthcoming year.

Please find attached an Application Form & Guidance Notes for the Council's Shop Front Grant Scheme for information for your members/clients. Details are also available to download from www.scotborders.gov.uk/shopfronts

If you have any initial queries with regards the Scheme, please contact my colleague Julie Hogg on 01835 826527 or email shopfronts@scotborders.gov.uk

Investing in Communities

The BIG Lottery Fund has today launched its new Investing in Communities funding programme. The fund aims to bring real improvements to communities, tackling need and addressing inequality.

The programme runs from 30th June 2010 to 30th June 2015 with grants of between £10,000 and £1 million available through three investment programmes:

- Growing Community Assets - aims to help communities have more control and influence over their own future through ownership of assets
- Life Transitions - aims to support projects that help people at key times of change, helping them to make their lives better for the future
- Support 21st Century Life - aims to support projects that build stronger families and stronger communities

You'll find lots of information on the application process, what kind of projects they're looking to fund and where to get help on the Investing in Communities section of the BIG Lottery Fund website: www.biglotteryfund.org.uk



Funding for Broadband!

Does your community have an idea for a broadband project? If so, you could bid in to a new one million Euro challenge fund, announced by the Scottish Government, which aims to improve the coverage and the speed of broadband in rural areas.

The Rural Broadband Challenge Fund will be delivered through the LEADER Programme which supports small-scale, community driven projects in rural Scotland. Examples of possible projects for the new challenge fund include the upgrade of exchanges, pilot projects into next generation broadband and supporting a business collective to access better broadband.

For more information in:

Dumfries & Galloway go to Ros Halley @ Ros.halley@dumgal.gov.uk

Scottish Borders go to Maria MacKenzie @ scotbordersleader@scotborders.gov.uk

West Lothian go to Avril Wallace @ avril.wallace@westlothian.gov.uk

Borders Family History Society has 2 new CD publications, Duns Monumental Inscriptions, and Innerleithen Monumental Inscriptions.

Duns Monumental Inscriptions includes the Hearth Tax of 1694, lists of the ministers of various churches, inscriptions on over 550 gravestones in the Parish Church and Christ Church burial ground, photographs of all the gravestones, Duns War Memorial, War Memorial 1914 -1919, Roll of Honor, memorial plaques, and indexes to the surnames in the inscriptions for both the burial grounds.

Innerleithen Monumental Inscriptions comprises a plan of Innerleithen in 1849, historical notes on Innerleithen parish, transcription of the Poll Tax of 1694 which lists 264 people including many couples, a list of the ministers of Innerleithen and Walkerburn churches, plans of Kirklands in Leithen Road and Traquair Road cemetery, interments in the Old Kirkyard, inscriptions on over 1200 gravestones in Kirklands and Traquair Road cemetery, photographs of all the gravestones, Innerleithen War Memorial, Walkerburn War Memorial, rolls of honour and other memorials, an obituary of Nannie Kirk, the Pipers Grave, list of Standard Bearers, as well as indexes of the surnames in the Poll Tax and the gravestone inscriptions.

Cost for either CD is £9 plus 51p for 2nd class UK postage. Please contact Mary Thomson on 01896 756798 or go to www.bordersfhs.org.uk/BFHSContacts.asp using the contact type Order for Publications.

In Need of some Financial Assistance?

- Do you require assistance with the OSCR regulations?
- Do you need someone to inspect your year-end accounts?
- Are you not sure which way to turn?

Then the Social Enterprise Chamber in partnership with Sue Bennett LCIE, a full member of the Association of Charity Independent Examiners, can give you some support and information.

Contact the office on 01835 822099 or e-mail sbsecfinance@btconnect.com

Scottish Borders Social Enterprise Chamber



1 Orchard Park
St Boswells MELROSE
Roxburghshire
TD6 0DA

Please send any items for the next newsletter to:

Tel: 01835 822099
or Email: borderssec@btconnect.com
www.sbsec.org.uk

Your Chamber Your Choice